

Collection of a Powder or Solid Sample

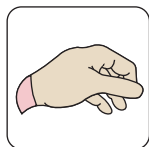

To help reduce your risk of exposure, wear appropriate PPE depending upon the threat, but at a minimum latex gloves and a mask.

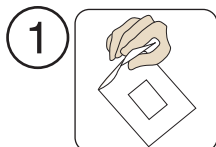

1. Tear open the inner white pouch to remove the test device. Place the device and the diluent tube onto a flat, horizontal surface in front of you.

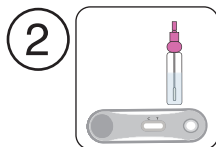

2. The test device should be placed in front of you with the "C" and "T" towards the top and the small round sample well to your right as shown above..

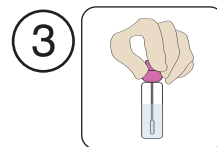

3. Unscrew the cap from the diluent tube. While removing the swab, rub the foam tip against the inside walls to extract excess liquid then remove the swab completely.

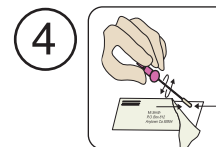

4. Swab the suspect material or contaminated area carefully. Collect as much material as possible by swirling the swab tip slowly.

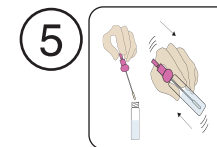

5. Return the swab and collected sample back to the diluent tube. Tighten the cap and gently shake the tube for approximately 5 seconds.

***Please proceed to number 6**

Collection of Samples from a Liquid

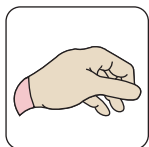

To help reduce your risk of exposure, wear appropriate PPE depending upon the threat, but at a minimum latex gloves and a mask.

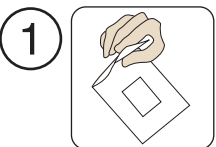

1. Tear open the inner white pouch to remove the test device. Place the device and the diluent tube onto a flat, horizontal surface in front of you.

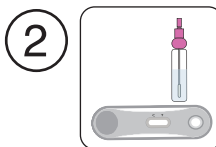

2. The test device should be placed in front of you with the "C" and "T" towards the top and the small round sample well to your right as shown above..

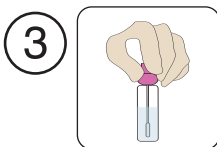

3. Place the absorbent end of the swab back into the microtube containing the sample diluent and swirl for 10 seconds to remove the collected sample.

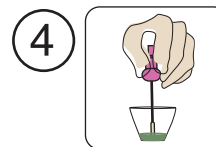

4. Place the absorbent end of the swab into the suspect liquid and swirl for 5 seconds.

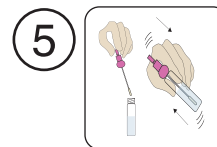

5. Return the swab and collected sample back to the diluent tube. Tighten the cap and gently shake the tube for approximately 5 seconds.

***Please proceed to number 6**

Test Instructions

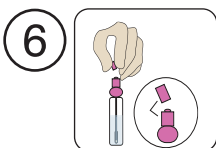

1. Remove the clear cap from the tip of the diluent tube. Break off the tip and discard. The tube now becomes a dropper for dispensing the sample onto the test device.

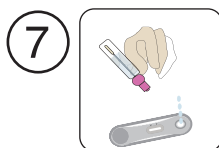

2. Invert the tube to a 45 degree angle and SLOWLY add 5 to 6 drops to the sample well. DO NOT add more than 6 drops. Return the clear cap back to the dropper and set it to the side.

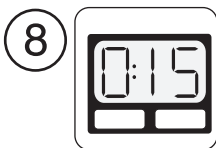

3. Set a timer and allow a maximum of 15 minutes before interpreting the results. You may see results in as little as 3 minutes. DO NOT interpret results after 30 minutes

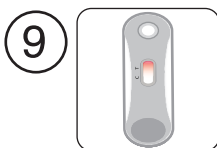

4. As the test begins to work, a reddish color will begin moving across the result window. A line should always appear at the control line (C). This is an indication that the test is working correctly.

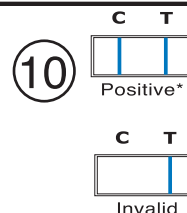

5. The windows above represent potential results. A weak positive, regardless of its intensity, should be considered positive. Invalids are rare but occur when tests are out-dated or exposed to extreme weather and should be re-run.

**Any visible line regardless of intensity in the test area should be viewed as a positive result.*

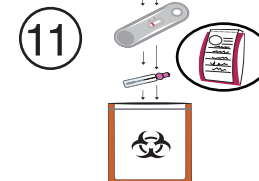

6. With your results collected, return all items back to the original zip-lock foil pouch. Zip the pouch closed, complete the chain of custody label, remove the adhesive backing and attach it over the pouch. Pouch is now ready for the lab..