

Description

The Pro Strips 5 bioterror screening device is a simple-to-use Hand-Held Assay (HHA) for rapid, qualitative detection of Anthrax, Ricin toxin, Botulinum toxin, Y. pestis and SEB. A confirmatory evaluation is recommended.

Important Information

Please review complete instructions prior to use. Use only the materials supplied in this kit.

Always use proper PPE or refer to your organizations's written protocol.

Humidity levels above 80% can slow results. Do not use in direct rain.

Device works best in temperatures between 38 and 90 degrees fahrenheit or 4 to 32 degrees celsius.

Maximum temperature range:
34 to 120 degrees fahrenheit
1 to 49 degrees celsius.

DO NOT open the inner white pouch until you are ready to perform the evaluation.

Contact Us

Advnt Biotechnologies LLC. USA
888-223-3269
Emergency information 24/7
602-803-1535
Technical info can also be found at
www.advnt.org

Pro Strips and the Pro Strips logo are registered trademarks of Advnt Biotechnologies 2009

Test Kit Equipment



Dropper/Swab Diluent tube

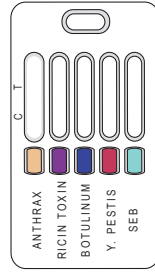

Pouched Test Device



Chain of Custody label



Folded instruction insert

Rev. 2 11/08

①

②

③

④

⑤

Tear open the inner white pouch to remove the test device. Place the device and the diluent tube onto a flat, horizontal surface in front of you.

The test device should be placed in front of you with the text to your left and the sample well to the right as shown above.

Unscrew the cap from the diluent tube. While removing the swab, rub the foam tip against the inside walls to extract excess liquid then remove the swab completely.

Swab the suspect material or contaminated area carefully. Collect as much material as possible by swirling the swab tip slowly.

Return the swab and collected sample back to the diluent tube. Tighten the cap and gently shake the tube for approximately 5 seconds. Move to step 6.

①

②

③

④

⑤

Collection of a liquid sample

Tear open the inner white pouch to remove the test device. Place the device and the diluent tube onto a flat, horizontal surface in front of you.

The test device should be placed in front of you with the text to your left and the sample well to the right as shown above.

Unscrew the cap from the diluent tube. While removing the swab, rub the foam tip against the inside walls to extract excess liquid then remove the swab completely.

Place the absorbent end of the swab into the suspect liquid and swirl for 5 seconds.

Return the swab and collected sample back to the diluent tube. Tighten the cap and gently shake the tube for approximately 5 seconds. Move to step 6.

6

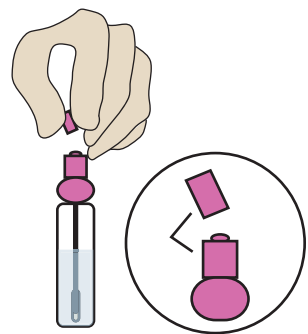

7

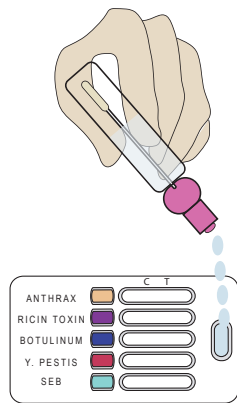

8



9

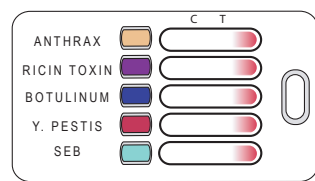

10

Test Results

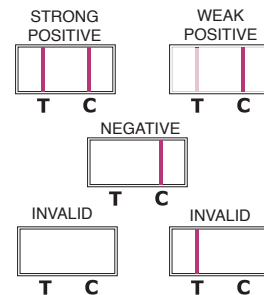

11

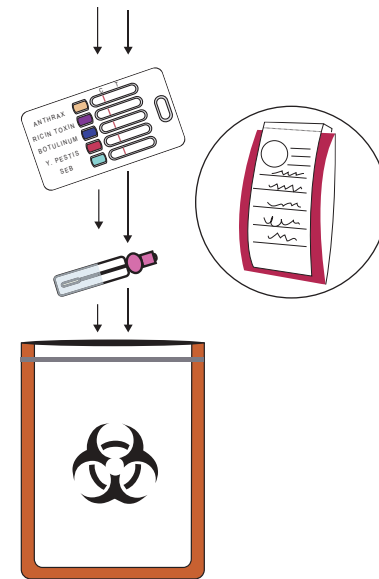

Remove the clear cap from the tip of the diluent tube. Break off the tip and discard. The tube now becomes a dropper for dispensing the sample onto the test device

Invert the tube to a 45 degree angle and VERY SLOWLY add 10 to 11 drops to the sample well. DO NOT add more than 11 drops. (11 drops = 0.55 - 0.60ml) Return the clear cap back to the dropper and set it to the side.

Set a timer and allow a maximum of 15 minutes before interpreting the results. You may see results in as little as 3 minutes. DO NOT interpret results after 30 minutes

As the test begins to work, a reddish color will move across the five (5) result windows. Lines should always appear at the control line (C) This is an indication that the test is working correctly.

The windows above represent potential results. A weak positive, regardless of its intensity, should be considered positive. Invalids are rare but occur when tests are out-dated or exposed to extreme weather and should be re-run.

With your results collected, return all items back to the original zip-lock foil pouch. Zip the pouch closed, complete the chain of custody label, remove the adhesive backing and attach it over the pouch. Pouch is now ready for the lab.



INSTRUCTION SHEET

PS-5T

5

ANTHRAX • RICIN • BOTULINUM
Y. PESTIS • SEB